

# TRIPLE RETRACTABLE STEP ASSEMBLY

164194

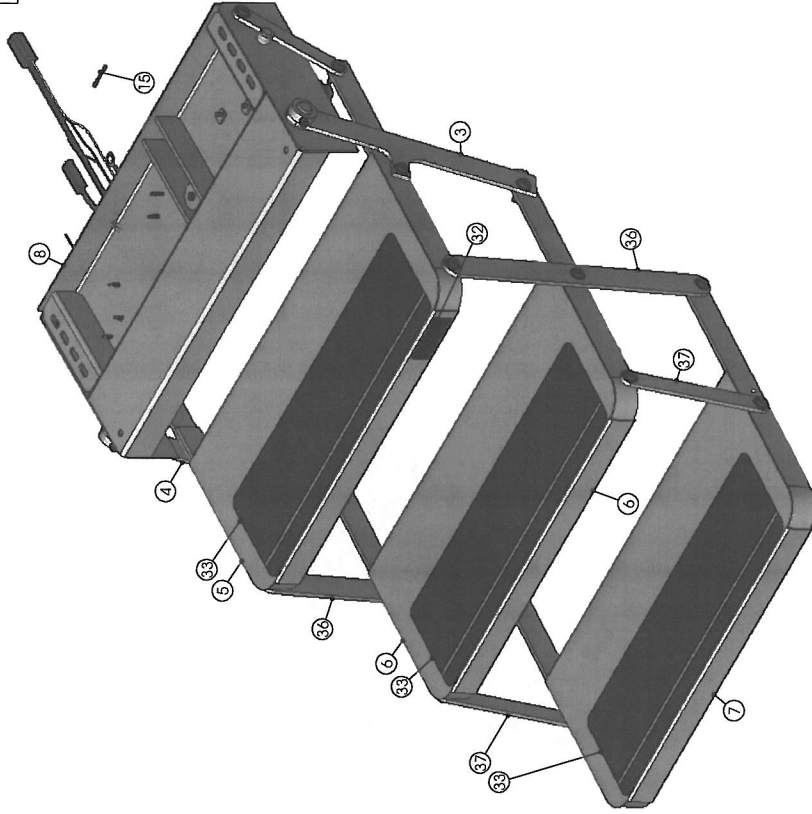

ITEM	PART NO.	CONFIG	DESCRIPTION	NAME	GA	QTY
1	165220	Default	BALL JOINT ASSEMBLY	MISC ASSY		2
2	162986	Default	COACH STEP DRIVE SHAFT	SUB ASSY		1
3	163500	Default	LH DOUBLE STEP DRIVE ARM	SUB ASSY		1
4	163502	Default	RH DOUBLE STEP DRIVE ARM	SUB ASSY		1
5	164188	Default	TRIPLE: TOP STEP	SUB ASSY		1
6	164218	Default	TRIPLE: MIDDLE STEP	SUB ASSY		1
7	164222	Default	TRIPLE: BOTTOM STEP	SUB ASSY		1
8	164346	Default	TRIPLE STEP BASE	SUB ASSY		1
9	164348	Default	TRIPLE STEP: GEAR PLATE ASSEMBLY	SUB ASSY		1
10	217252	Default	WASHER - 5/8" X 1.78 X .160; FLAT; BLACK ZINC			1
11	181351	Default	# 12 X 1.000 HEX HEAD WASHER TEK SCREW W/ B/S WASHER, ZINC PLATED			7
12	181440	Default	NUT 5/16 - 18 OVAL CONE GRADE 5; BLACK			18
13	116531	Default	BRONZE BUSHING; O.D. .501; I.D. .377	BUSHING		18
14	116532	Default	COPPER BUSHING; O.D. 1.252; I.D. .938 W/RIB	BUSHING		3
15	157474	Default	CONNECTOR; BUTT BRUCE 22-18 AWG	CONNECTOR		1
16	163669	Default	MOTORIZED COACH STEP MOTOR	ELECTRIC MOTOR		1
17	164889	Default	STEP MODULE	ELECTRICAL		1
18	165048	Default	MOTORIZED STEP LIGHT	ELECTRICAL		1
19	117889	Default	NUT - 1/4 - 20; FLANGE LOCK; ZN	FASTENER		1
20	118152	Default	WASHER - 1/4; USS FLAT WASHER ZINC	FASTENER		3
21	118152	Default	BOLT - 1/4 - 20 X 2.4; TAP BOLT GR5 ZINC	FASTENER		1
22	128952	Default	BOLT - 0.313 - 18 X 1.250 W/0.375 HEX HEAD SHOULDER	FASTENER		18
23	128969	Default	5/16 - 14 X 3 1/4 SOCKET HEAD CAP SCREW W/2.500 SHOULDER	FASTENER		1
24	128970	Default	5/16 - 18 X 1.523 SOCKET HEAD CAP SCREW W/1.238 SHOULDER	FASTENER		2
25	142996	Default	BOLT - 5/16 - 18 X 1; HEX TAP BOLT GR5 ZINC	FASTENER		2
26	165215	Default	NUT - 3/8 - 24; NUT JAM THREAD	FASTENER		2
27	165216	Default	WASHER - 6MM (GLOC) ZINC	FASTENER		3
28	165218	Default	WASHER; 875 O.D. X .410 I.D. X .015 (BLACK ZINC)	FASTENER		28
29	179881	Default	NUT - 3/8 - 24 CONE FLANGE LOCK ZN	FASTENER		2
30	183925	Default	BOLT - 10 X 63.5MM HEX CAP SCREW GR5 ZINC	FASTENER		3
31	198352	Default	NUT - 5/16 - 18; NYLON INSERT LOCK NUT SUPER BLACK	FASTENER		2
32	90600753	Default	LABEL COA-CH STEP 1.125 X 3.125	LABEL (ETCH)		1
33	164958	Default	ANTI-SKID TAPE; 21.000 X 6.000	MISC		3
34	165298	Default	3/8" P-CLAMP	MISC		1
35	128947	Default	1.400X1.800	Plate		16
36	128912	Default	17.000X1.500	PLT		2
37	162364	Default	9.000 X 1.000	PLT		1/4
38	162398	Default	6.950 X 3.800	PLT		16
39	163495	Default	7.000 X 1.000	PLT		1/4
40	128955	Default	.375-.4 X 2.25; THREADED ROD	ROD		1
41	128958	Default	2501.D. X .500 O.D. X .370	ROD		6
42	128959	Default	.750 X .600	ROD		2
43	163492	Default	.700 X 1.000 BUMPER	RUBBER BUMPER		6

REV.	DATE	INIT.	DESCRIPTION
A	5/21/2007	C.GREER	APPROVED & RELEASED
B	5/23/2007	B.CHARTIER	ADDED ELECTRICAL COMPONENTS TO DRAWING
C	5/31/2007	B.CHARTIER	ADDED GROUND WIRE, P-CLAMP & REPLACED MOTOR MOUNT BOLTS WITH METRIC
D	6/22/2007	J.CASHEN	UPDATED ASSEMBLY WITH NEW BASE
E	10/3/2007	C.GREER	UPDATED PRINT WITH REVISED PARTS
F	2/20/2008	D.COCHRAN	ADDED 157480 & REPLACED 118230 WITH 178598
G	4/1/2008	R.WAGNER	REPLACED 119072 W/ 179881, REPLACED 128953 & 128954 W/ 165220
H	4/16/2008	D.COCHRAN	REMOVED 163877
J	4/23/2008	NM	REPLACED 178598 WITH 181351
K	5/2/2008	NM	REPLACED 117891 WITH 181440, ADDED 165215
L	6/13/2008	NM	REPLACED 1190755 W/ 165218, ADDED 177063
M	6/30/2008	G-G	REPLACED 165213 WITH 183925
N	10/10/2008	ENG	SHOW UPDATES TO SUB ASSEMBLIES
P	2/2/2009	GR	CHANGED QTY OF 165218 FROM 18 TO 36
R	6/4/2009	EGR	REPLACED 157480 W/ 157474
T	6/11/2009	JMM	FIXED STAP THAT WAS OVERLAPPING
U	7/17/2009	EGR	REPLACED 118130 W/ 217252
V	8/17/2009	NM	ADDED ANTI SKID TAPE (164958)
W	11/16/2010	EGR	DELETED EIGHTEEN 165218 FROM BOM

**PROPRIETARY AND CONFIDENTIAL**  
THE INFORMATION CONTAINED IN THIS DRAWING IS THE SOLE PROPERTY OF LIPPERT COMPONENTS, INC. ANY REPRODUCTION IN PART OR AS A WHOLE WITHOUT THE WRITTEN PERMISSION OF LIPPERT COMPONENTS, INC. IS PROHIBITED.

DRAWING NOTES:  
DIMENSIONS ARE IN INCHES  
TOLERANCES:  
FRACTIONAL: +.1 / .132"  
XX: +.1 / .003  
ANGLE: +.1 / 1 DEGREE

DRAWN BY: JSC  
DATE: 05/17/07  
APPROVED BY:

**LIPPERT**  
A Lippert Components Subsidiary

**LIPPERT COMPONENTS, INC.**  
2703 College Ave.  
Goshen, IN 46528  
(574) 535-1125 Phone  
(574) 975-2883 Fax

DWG. NO. 164194

SCALE: 1:10  
PAGE: 1 OF 4

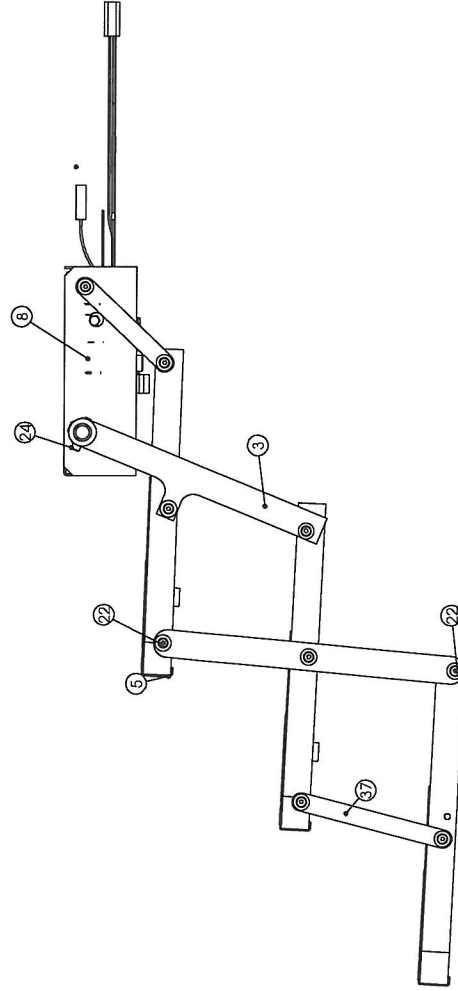
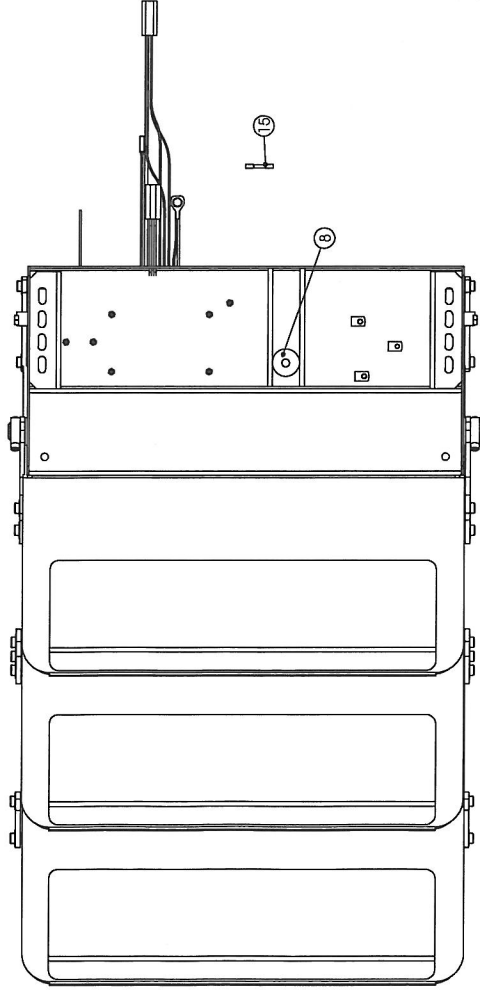
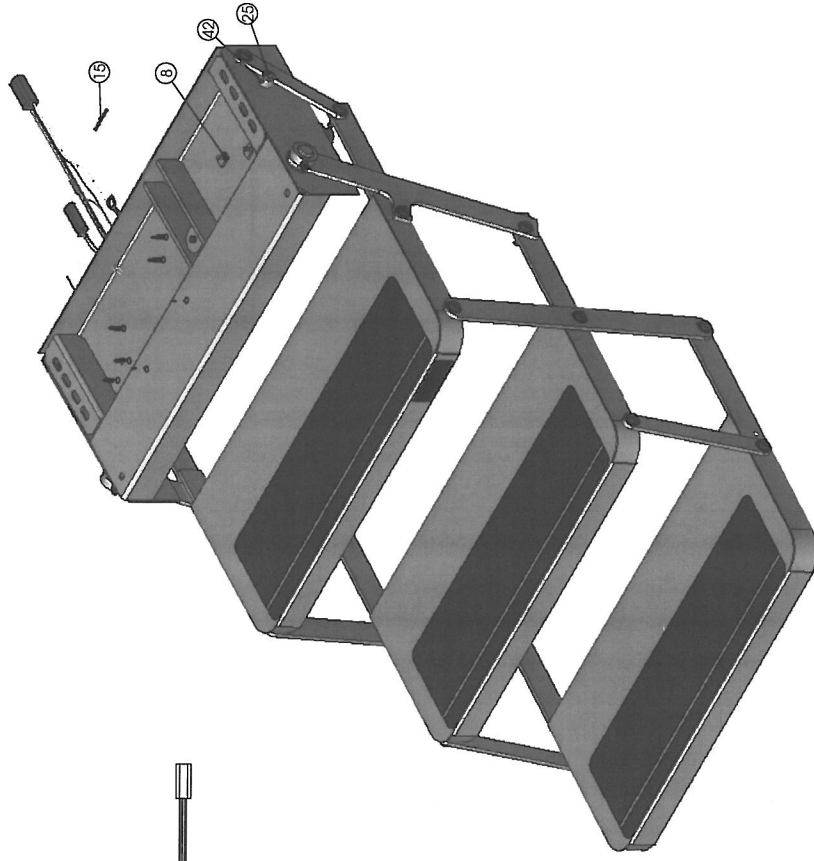

**PROPRIETARY AND CONFIDENTIAL**  
THE INFORMATION CONTAINED IN THIS  
DRAWING IS THE SOLE PROPERTY OF  
LIPPERT COMPONENTS, INC. ANY  
REPRODUCTION IN PART OR AS A WHOLE  
WITHOUT THE WRITTEN PERMISSION OF  
LIPPERT COMPONENTS, INC. IS PROHIBITED.

**DRAWING NOTES:**  
DIMENSIONS ARE IN INCHES  
TOLERANCES:  
FRACTIONAL:  $\pm 1/32$ "  
XX:  $\pm 0.00$   
XX:  $\pm 0.01$   
ANGLE:  $\pm 1$  DEGREE

DRAWN BY:	NAME	DATE
APPROVED BY:	JSC	05/17/07

**LIPPERT**

**LIPPERT COMPONENTS, INC.**  
A Lippert Components Subsidiary



2703 College Ave.  
Goshen, IN 46528  
(574) 535-1125 Phone  
(574) 975-2883 Fax

DWG. NO. **164194**

REV. **W**

SCALE: 1:10

PAGE: 3 OF 4

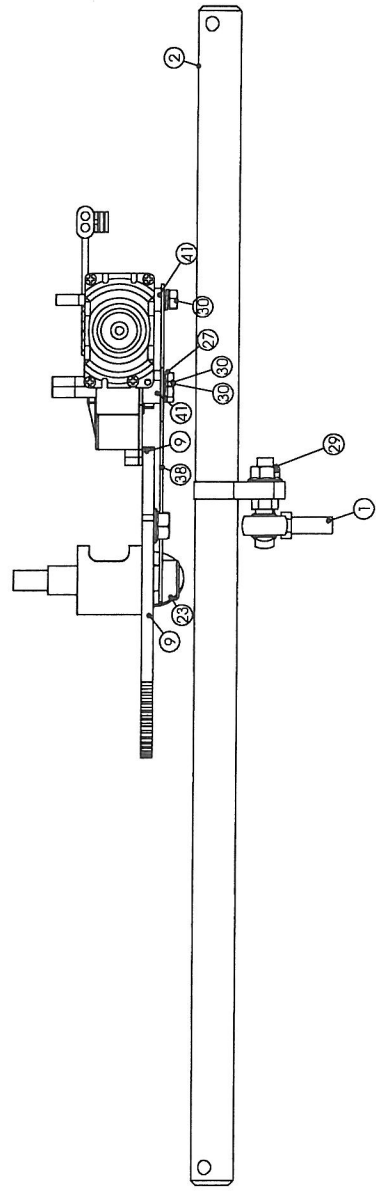
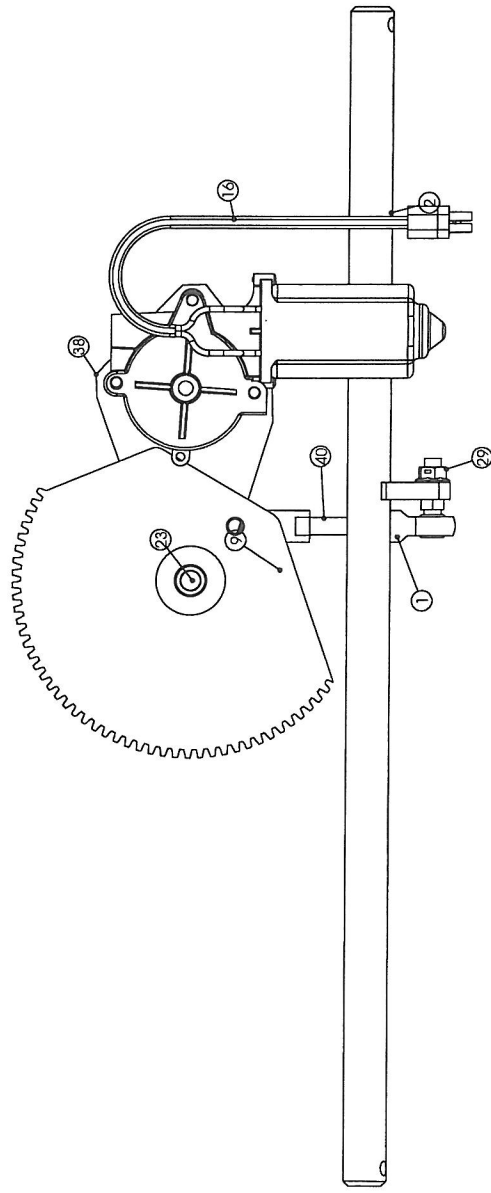
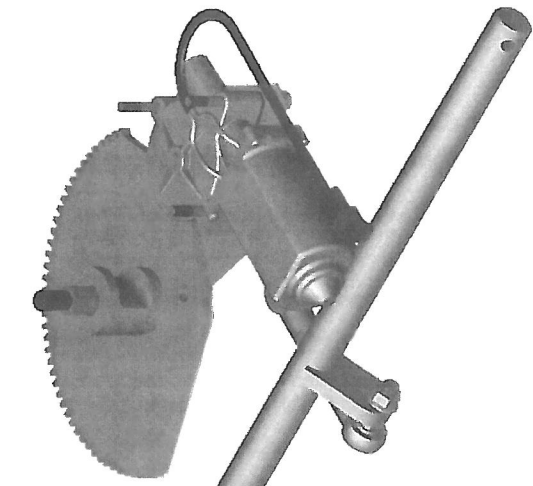

LIPPERT

LIPPERT COMPONENTS, INC.  
A Lippert Components Subsidiary



2703 College Ave.  
Goshen, IN 46528  
(574) 535-1125 Phone  
(574) 975-2883 Fax

DWG. NO.	164194	REV.	W
SCALE:	1:4	PAGE:	4 OF 4

PROPRIETARY AND CONFIDENTIAL  
THE INFORMATION CONTAINED IN THIS  
DRAWING IS THE SOLE PROPERTY OF  
LIPPERT COMPONENTS, INC. AND IS  
NOT TO BE REPRODUCED OR  
REPRODUCED IN PART OR AS A WHOLE  
WITHOUT THE WRITTEN PERMISSION OF  
LIPPERT COMPONENTS, INC. IS PROHIBITED.

DRAWN BY:	NAME	DATE
JSC	JSC	05/17/07
APPROVED BY:		

DRAWING NOTES:  
DIMENSIONS ARE IN INCHES  
DECIMALS:  $\pm 0.005$   
FRACTIONAL:  $\pm 1/32"$   
XX:  $\pm 0.03$   
XXX:  $\pm 0.010$   
ANGLE:  $\pm 1$  DEGREE

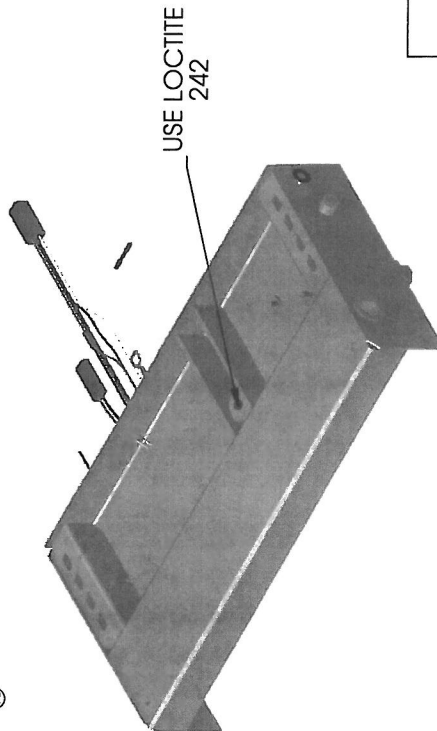
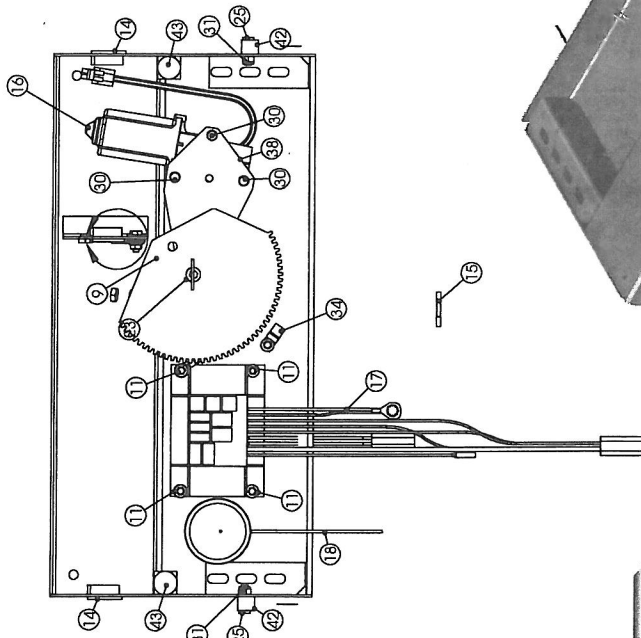
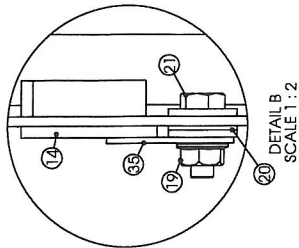
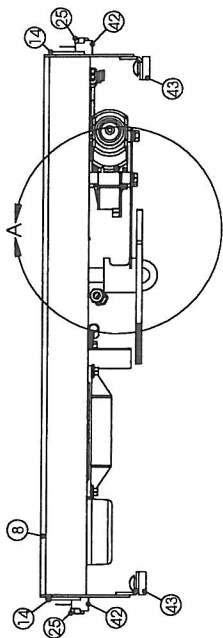

USE LOCTITE  
242

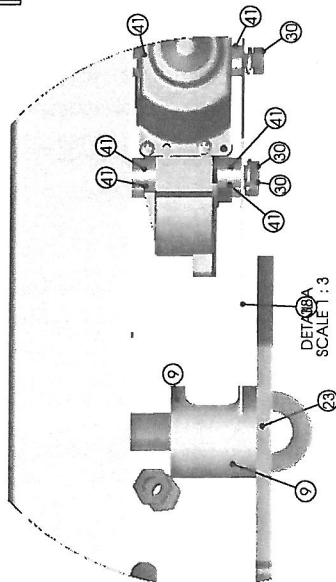

LIPPETT

LIPPETT COMPONENTS, INC.  
A Lippert Components Subsidiary



2703 College Ave.  
Goshen, IN 46528  
(574) 535-1125 Phone  
(574) 975-2883 Fax

DWG. NO. 164194  
SCALE: 1:8  
REV. W  
PAGE: 2 OF 4

PROPRIETARY AND CONFIDENTIAL  
THE INFORMATION CONTAINED IN THIS  
DRAWING IS THE PROPERTY OF  
LIPPETT COMPONENTS, INC. ANY  
REPRODUCTION IN PART OR AS A WHOLE  
WITHOUT THE WRITTEN PERMISSION OF  
LIPPETT COMPONENTS, INC. IS PROHIBITED.

DRAWING NOTES:  
DIMENSIONS ARE IN INCHES  
TOLERANCES:  
FRACTIONAL:  $\pm 1/32$   
XX:  $\pm 0.03$   
XXX:  $\pm 0.010$   
ANGLE:  $\pm 1$  DEGREE

DRAWN BY: JSC  
DATE: 05/17/07  
APPROVED BY: